

4. SDG

Bohrstange
boring bar

HERZSCHRITTMACHER Elektroden Komponente

PACEMAKER
component of the electrodes

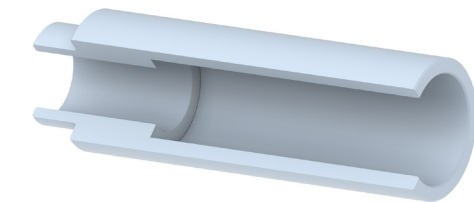

HOBE



RAGOTZKY+GATJE

Holtenuer Strasse 284, 24106 Kiel | mail@ragotzkygaetje.de | 0431-389080
ragotzkygaetje.de | shop.ragotzkygaetje.de | spannsysteme-shop.de

HANS TREIBER

Gutenbergstrasse 19, 24558 Henstedt-Ulzburg | 04193-77943
mail@hanstreiber.de | shop.hanstreiber.de | fraeser-shop.de

HOBE



HÜFTENDOPROTHESE Kunstpfanne aus Polyethylen

HIP SOCKET
artificial cup out of polyethylene

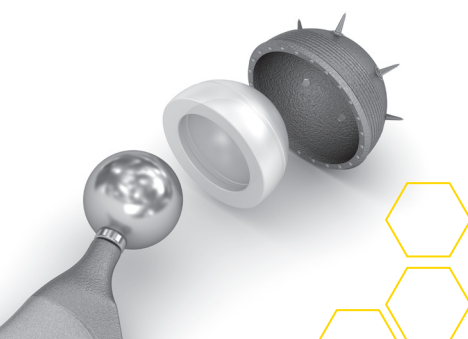

10. SXJ

Stirn-Kopierstahl
front copying cutter

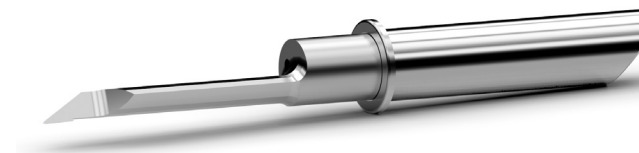
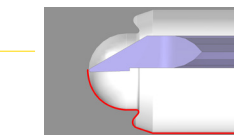

Humanmedizinische Instrumente, Implantate und Prothesen müssen höchste Qualitätsansprüche erfüllen. Nur so können gesundheitliche Risiken abgewendet und eine lange Produktlebensdauer erreicht werden. Das Hobe micro tools Sortiment hält eine große Auswahl an VHM-Hochleistungswerkzeugen bereit, die für die Produktion medizinischer Hilfsmittel bestens geeignet sind.

Human medical instruments, implants and prostheses require the highest quality standards. This is the only way to avoid health risks and achieve a long product life. The Hobe micro tools range includes a wide range of VHM high performance tools that are ideal for medical device production.

Hard-to-machine materials (e.g. platinum, titanium and others) present us with special challenges in tool development - which we gladly accept.

Through intensive exchange with our customers, we have in-depth process knowledge in the field of implant prosthetics and dental technology.

Our expertise in machining leads to convincing results in terms of surface quality and accuracy of fit.

Hobe GmbH | micro tools
Baindter Straße 27
88255 Baienfurt
Germany

+49 (0)751 56092 0
+49 (0)751 56092 18
info@hobe-tools.de
www.hobe-tools.de

Medizintechnik und Implantologie

Medical Technology and Implantology

micro-tooling
Ø > 0,33 mm



www.hobe-tools.de

- höchste Genauigkeit im System
- schneidend bis ins Zentrum
- problemlose Abbildung von Kugelformen
- sehr glatte Werkstückoberfläche

- ultra high accuracy
- cutting to the core
- easy reproduction of spherical shapes
- very smooth surface of the machined part

www.hobe-tools.de

© 2023 - All rights reserved by Hobe GmbH

Edition 43.0008

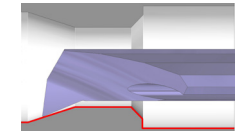

1. SDH
Hinterdrehstahl
back-off cutter

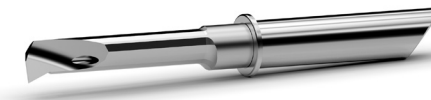

- höchste Genauigkeit im System
- Hinterdrehen und Hinterstechen im Bohrloch
- spiralgenutet zur besseren Spanbildung

- ultra high accuracy
- back-off cutting and producing undercuts in the borehole
- spiral fluted for better chip formation

DORSALE STABILISIERUNG
Pedikelschraube

DORSAL STABILISATION
pedicle screw

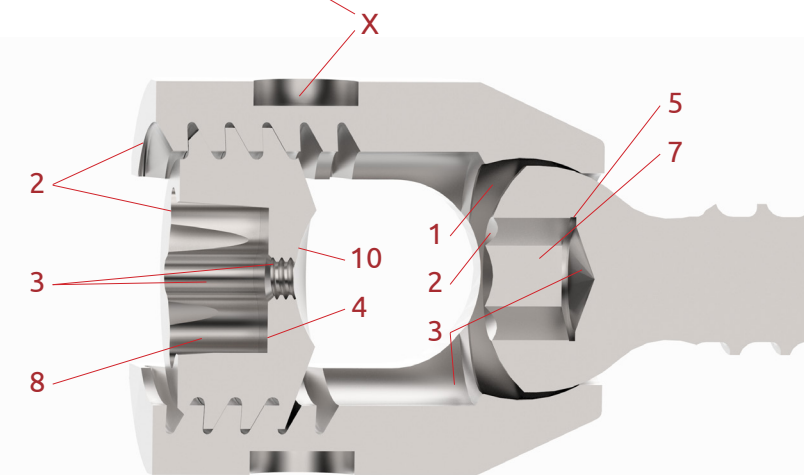
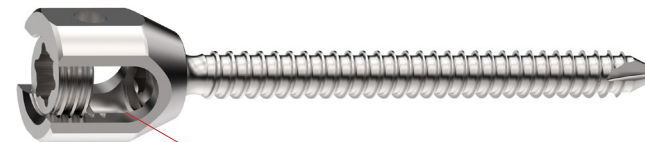

X = Spezialwerkzeug | custom tool

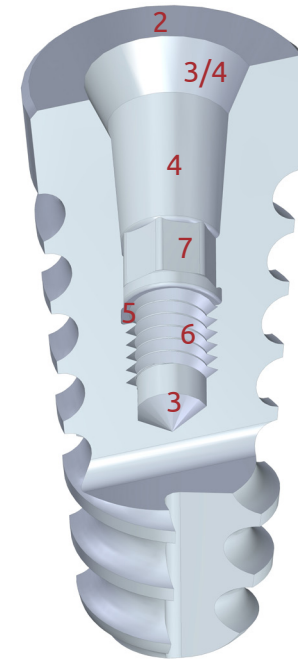

DENTALIMPLANTAT
Innenkontur Zahnimplantat

DENTAL IMPLANT
inner shape of a dental implant

<p>2. DRP Punktanbohrer centering pointer</p> 	<p>3. DRA Anfasbohrer chamfering drill</p> 	<p>4. SDG Bohrstange boring bar</p> 	<p>5. SDS Innen-Einsteichstahl internal grooving cutter</p> 	<p>6A. SDU Gewindedrehstahl threading cutter</p> 	<p>6B. WHN Gewindewirbler thread whirler</p> 	<p>7. BRH 8. BRT Stoßwerkzeug broaching tool</p> 
--	---	--	--	---	---	--

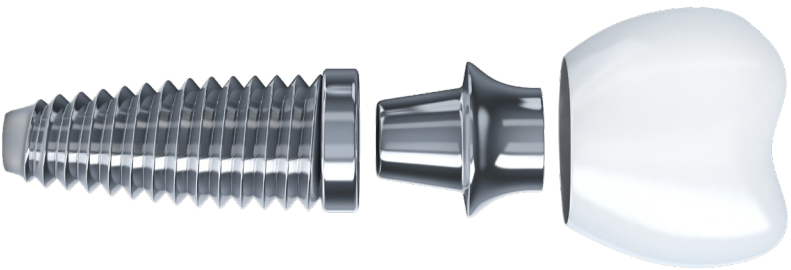

ENDOSKOPIE
Rohr- und Linsensitz

ENDOSCOPY
tube- and lense fitting

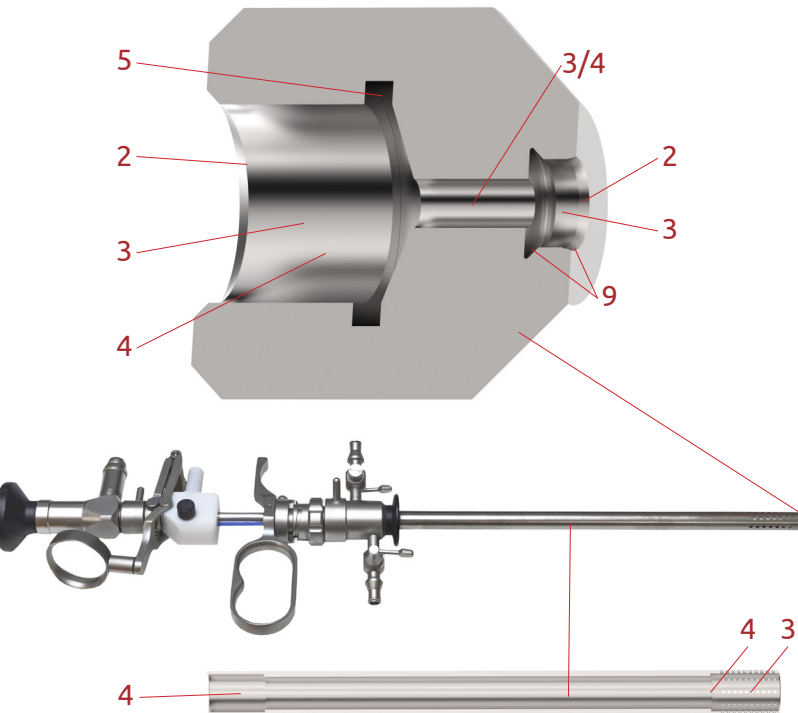

9. SDW
Auskammerstahl
chamfering tool

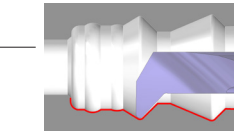

- höchste Genauigkeit im System
- Auskammern und Anfasen in Einem
- spiralgenutet zur besseren Spanbildung
- nach hinten 47° frei zur Erstellung von Fasen
- ultra high accuracy
- chamfering and chamfering within one tool
- spiral fluted for better chip formation
- backwards chamfer due to 47° angle